

**NOTICE!!**

**These documents have been scanned!**

**Do not place un-scanned documents beneath this notice!**

**Do not remove this notice from this file!**

GPO Jacket No. 560-102  
Print Order 61540  
Rise Business Services, LLC  
Job=AZ15 5/10/2019



Box Number= AZ15036



Claim Begin-End: AMC425510-AMC425510

1 Initial Receipt



AZ15036-19

AMC425096-AMC425592

**United States Department of the Interior**  
**Bureau of Land Management**  
 LANDS/RECREATION & PLANNING  
 ONE N CENTRAL AVE  
 PHOENIX, AZ 85004 -2203  
 Phone: 602-417-9200

**ENTERED**  
 NOV 22 2013  
 BY: *pm* No: \_\_\_\_\_

Receipt

2912218

<b>Transaction #:</b> 2999090	
<b>Date of Transaction:</b> 11/18/2013	
CUSTOMER:	
KRIS HENDRICKS 2915 W MALIBU RD GOLDEN VALLEY, AZ 86413-8819 US	

LINE #	QTY	DESCRIPTION	REMARKS	UNIT PRICE	TOTAL
1	1.00	LOCATABLE MINERALS / MINING CLAIMS-NEW, UNADJUD, ONE OR MORE AUTH NOS / NEW MINING CLAIM LOCATION FEE \$34 <b>CASES: AMC425510/\$34.00</b>		- n/a -	34.00
2	1.00	LOCATABLE MINERALS / MINING CLAIMS-NEW, UNADJUD, ONE OR MORE AUTH NOS / NEW MINING CLAIM PROCESSING FEE \$20 <b>CASES: AMC425510/\$20.00</b>		- n/a -	20.00
3	1.00	LOCATABLE MINERALS / MINING CLAIMS-NEW, UNADJUD, ONE OR MORE AUTH NOS / NEW MINING CLAIM MAINT FEE \$140 <b>CASES: AMC425510/\$140.00</b>		- n/a -	140.00
<b>TOTAL:</b>					<b>\$194.00</b>

PAYMENT INFORMATION			
NOTE: Items will appear on credit card statement as "Bureau of Land Mgmt CO".			
1	AMOUNT:	194.00	POSTMARKED: N/A
	TYPE:	CREDIT CARD	RECEIVED: 11/15/2013
	NAME:	HENDRICKS, KRIS 2915 W MALIBU RD GOLDEN VALLEY AZ 86413-8819 US	
	CARD NO:	XXXXXXXXXXXX6086	AUTH CODE: 018854
	NAME ON CARD:	KRISTOPHER HENDRICKS	
	EXPIRES:	03/2015	
	SIGNATURE:		

REMARKS

This receipt was generated by the automated BLM Collections and Billing System and is a paper representation of a portion of the official electronic record contained therein.



**NOTICE!!**

**These documents have been scanned!**

**Do not place un-scanned documents beneath this notice!**

**Do not remove this notice from this file!**

GPO Jacket No. 560-102  
Print Order 61540  
Rise Business Services, LLC  
Job=AZ15 5/10/2019



Box Number= AZ15036



Claim Begin-End: AMC425510-AMC425510

2 Correspondence



AZ15036-19

AMC425096-AMC425592



**NO  
DOCUMENTS  
FOUND**

NO DOCUMENTS FOUND  
NO DOCUMENTS FOUND

**NOTICE!!**

**These documents have been scanned!**

**Do not place un-scanned documents beneath this notice!**

**Do not remove this notice from this file!**

GPO Jacket No. 560-102  
Print Order 61540  
Rise Business Services, LLC  
Job=AZ15 5/10/2019



Box Number= AZ15036



Claim Begin-End: AMC425510-AMC425510

3 Transfers



AZ15036-19

AMC425096-AMC425592

• •

**NO  
DOCUMENTS  
FOUND**

NO DOCUMENTS FOUND  
NO DOCUMENTS FOUND



**NOTICE!!**

**These documents have been scanned!**

**Do not place un-scanned documents beneath this notice!**

**Do not remove this notice from this file!**

GPO Jacket No. 560-102  
Print Order 61540  
Rise Business Services, LLC  
Job=AZ15 5/10/2019



Box Number= AZ15036



Claim Begin-End: AMC425510-AMC425510

4 Miscellaneous



AZ15036-19

AMC425096-AMC425592

**NO  
DOCUMENTS  
FOUND**

NO DOCUMENTS FOUND  
NO DOCUMENTS FOUND

**NOTICE!!**

**These documents have been scanned!**

**Do not place un-scanned documents beneath this notice!**

**Do not remove this notice from this file!**

GPO Jacket No. 560-102  
Print Order 61540  
Rise Business Services, LLC  
Job=AZ15 5/10/2019



Box Number= AZ15036



Claim Begin-End: AMC425510-AMC425510

5 Annual Filings



AZ15036-19

AMC425096-AMC425592



UNITED STATES  
DEPARTMENT OF THE INTERIOR  
BUREAU OF LAND MANAGEMENT

AMC 425510

**CREDIT CARD PAYMENT**  
**For Mining Claim Maintenance Fee**

THIS IS A CHANGE OF ADDRESS

TELEPHONE SUBMISSION - ACCURACY OF THE BELOW INFORMATION IS THE RESPONSIBILITY OF THE CLAIMANT/OWNER

NAME Kris Hendricks  
ADDRESS 2915 W. Malibu  
CITY Golden Valley STATE AZ ZIP 86413  
PHONE # 928 - 323-2683

SEND RECEIPT TO  Above address  
 Other (Include Name and Mailing Address):  
\_\_\_\_\_  
\_\_\_\_\_  
\_\_\_\_\_

AMC NUMBER  
425510

CLAIM/SITE NAME  
Burro Corral 1

1 # of Claim/Site  
x 165.00 Each  
\$ 165 Total Charged EG (INITIALS)

RECEIPT # 4546208

DATE STAMP

RECEIVED  
BLM AT STATE OFFICE  
2019 AUG 28 A 11:00  
PHOENIX, ARIZONA

ENTERED  
SEP 03 2019

\*\*\*\* FOR OFFICIAL USE ONLY \*\*\*\*  
DATE \_\_\_\_\_ INITIALS \_\_\_\_\_ VERIFIED \_\_\_\_\_

**United States Department of the Interior**  
**Bureau of Land Management**  
 DIV OF LANDS, MINRLS & ENERGY  
 ONE N CENTRAL AVE  
 PHOENIX, AZ 85004 -4427  
 Phone: 602-417-9200

Receipt

No: 4546208

<b>Transaction #:</b> 4667207	
<b>Date of Transaction:</b> 08/28/2019	
CUSTOMER:	
	KRIS HENDRICKS 2915 W MALIBU RD GOLDEN VALLEY, AZ 86413-8819 US

LINE #	QTY	DESCRIPTION	REMARKS	UNIT PRICE	TOTAL
1	1.00	LOCATABLE MINERALS / MINING CLAIMS- NOT NEW-UNADJUD, ONE AUTH NO. ONLY / MINING CLAIM MONEY RECEIVED <b>CASES: AMC425510/\$165.00</b>	2020 MAINT (1)	- n/a -	165.00
<b>TOTAL:</b>					<b>\$165.00</b>

PAYMENT INFORMATION			
NOTE: Items will appear on credit card statement as "Bureau of Land Mgmt CO".			
1	AMOUNT:	165.00	POSTMARKED: N/A
	TYPE:	CREDIT CARD	RECEIVED: 08/28/2019
	NAME:	HENDRICKS, KRIS 2915 W MALIBU RD GOLDEN VALLEY AZ 86413-8819 US	
	CARD NO:	XXXXXXXXXXXX6086	AUTH CODE: 028694
	NAME ON CARD:	KRISTOPHER HENDRICKS	
	SIGNATURE:	OVER THE PHONE	

REMARKS

This receipt was generated by the automated BLM Collections and Billing System and is a paper representation of a portion of the official electronic record contained therein.

UNITED STATES  
DEPARTMENT OF THE INTERIOR  
BUREAU OF LAND MANAGEMENT

425510

**CREDIT CARD PAYMENT**  
**For Mining Claim Maintenance Fee**

CHANGE OF ADDRESS

TELEPHONE SUBMISSION - ACCURACY OF THE BELOW INFORMATION IS THE RESPONSIBILITY OF THE CLAIMANT/OWNER

NAME CHRISTOPHER HENRICKS  
ADDRESS 2915 W MAUI BL  
CITY GOLDEN VALLEY STATE AZ ZIP 86143  
PHONE # 928 - 323 2683

SEND RECEIPT TO  Above address  
 Other (Include Name and Mailing Address):  
\_\_\_\_\_  
\_\_\_\_\_  
\_\_\_\_\_

AMC NUMBER  
AMC 425510

CLAIM/SITE NAME  
\_\_\_\_\_  
\_\_\_\_\_  
\_\_\_\_\_

1 # of Claim/Site  
x 155.00 Each  
\$ 155.00 Total Charged VER (INITIALS)

RECEIPT # \_\_\_\_\_

DATE STAMP

**ENTERED**  
**AUG 28 2018**  
BY: R4m

RECEIVED  
AZ STATE OFFICE  
2018 AUG 27 A 9:34  
PHOENIX, ARIZONA

\*\*\*\*\* FOR OFFICIAL USE ONLY \*\*\*\*\*  
DATE \_\_\_\_\_ INITIALS \_\_\_\_\_ VERIFIED \_\_\_\_\_



**United States Department of the Interior**  
**Bureau of Land Management**  
 DIV OF LANDS, MINRLS & ENERGY  
 ONE N CENTRAL AVE  
 PHOENIX, AZ 85004 -4427  
 Phone: 602-417-9200

Receipt

No: 4245626

<b>Transaction #:</b> 4361075	
<b>Date of Transaction:</b> 08/27/2018	
<b>CUSTOMER:</b>	
CHRISTOPHER HENDRICKS 2914 W MALIBU RD GOLDEN VALLEY,AZ 86413-8819 US	

LINE #	QTY	DESCRIPTION	REMARKS	UNIT PRICE	TOTAL
1	1.00	LOCATABLE MINERALS / MINING CLAIMS-NOT NEW-UNADJUD,ONE AUTH NO. ONLY / MINING CLAIM MONEY RECEIVED CASES: AMC425510/\$155.00	2019 MAINT/1	- n/a -	155.00
<b>TOTAL:</b>					<b>\$155.00</b>

PAYMENT INFORMATION			
NOTE: Items will appear on credit card statement as "Bureau of Land Mgmt CO".			
1	AMOUNT:	155.00	POSTMARKED: N/A
	TYPE:	CREDIT CARD	RECEIVED: 08/27/2018
	NAME:	HENDRICKS, CHRISTOPHER 2914 W MALIBU RD GOLDEN VALLEY AZ 86413-8819 US	
	CARD NO:	XXXXXXXXXXXX6086	AUTH CODE: 027590
	NAME ON CARD:	CHRISTOPHER HENDRICKS	
	SIGNATURE:		

REMARKS

This receipt was generated by the automated BLM Collections and Billing System and is a paper representation of a portion of the official electronic record contained therein.

Run Date: 09/05/17

Run Time: 02:33 PM

**DEPARTMENT OF THE INTERIOR  
BUREAU OF LAND MANAGEMENT  
MINING CLAIMS**

**MC Maintenance Fees Paid Through the BLM Pay Portal**

**CBS Receipt: 3963898**

Printed For Lead File # AMC425510

Agency Tracking ID: 1503947539

Assessment Year: 2018

Number of BLM Serial Nr: 1

Paid On: 08/28/2017

Total Amount Paid: \$155.00

Claim Name	BLM Serial No	Lead File No	Amount Paid
BURRO CORRAL #1	AMC425510	AMC425510	\$155.00

**United States Department of the Interior**  
**Bureau of Land Management**  
 BUSINESS & SUPPORT SVCS DIV  
 ONE N CENTRAL AVE SUITE 800  
 PHOENIX, AZ 85004 -4427  
 Phone: 602-417-9200

Receipt

No: 3963898

<b>Transaction #:</b> 4073771	
<b>Date of Transaction:</b> 08/28/2017	
CUSTOMER:	
KRISTOPHER HENDRICKS 2915 W MALIBU RD GOLDEN VALLEY, AZ 86413 US	

LINE #	QTY	DESCRIPTION	REMARKS	UNIT PRICE	TOTAL
1	1.00	LOCATABLE MINERALS / MINING CLAIMS- NOT NEW-UNADJUD, ONE AUTH NO. ONLY / MINING CLAIM MONEY RECEIVED <b>CASES:</b> AMC425510/\$155.00		- n/a -	155.00
<b>TOTAL:</b>					<b>\$155.00</b>

PAYMENT INFORMATION				
NOTE: Items will appear on credit card statement as "BLM O Mining Claim".				
1	AMOUNT:	155.00	POSTMARKED:	N/A
	TYPE:	CREDIT CARD	RECEIVED:	08/28/2017
	NAME:	KRISTOPHER HENDRICKS 2915 W MALIBU RD GOLDEN VALLEY AZ 86413 US		
	CARD NO:	XXXXXXXXXXXX6068	AUTH CODE:	028466
	NAME ON CARD:	KRISTOPHER HENDRICKS		
	EXPIRES:	03/2019		
	SIGNATURE:			

REMARKS

This receipt was generated by the automated BLM Collections and Billing System and is a paper representation of a portion of the official electronic record contained therein.

UNITED STATES  
DEPARTMENT OF THE INTERIOR  
BUREAU OF LAND MANAGEMENT

425510

**CREDIT CARD PAYMENT**  
**For Mining Claim Maintenance Fee**

THIS IS A CHANGE OF ADDRESS

TELEPHONE SUBMISSION - ACCURACY OF THE BELOW INFORMATION IS THE RESPONSIBILITY OF THE CLAIMANT/OWNER

NAME KRIS HENDRICKS  
ADDRESS 2915 W. MALIBU ROAD  
CITY GOLDEN VALLEY STATE AZ ZIP 86413  
PHONE # 928 - 323 - 2683

SEND RECEIPT TO  Above address  
 Other (Include Name and Mailing Address):  
\_\_\_\_\_  
\_\_\_\_\_  
\_\_\_\_\_

AMC NUMBER 425510 CLAIM/SITE NAME BURRO CORAL #1  
\_\_\_\_\_  
\_\_\_\_\_

1 # of Claim/Site  
x 155.00 Each  
\$ 155 Total Charged ML (INITIALS)

RECEIPT # 3645734

DATE STAMP

ENTERED  
AUG 30 2016  
BY: Ram

RECEIVED  
BLM AZ STATE OFFICE  
2016 AUG 29 P 3:15  
PHOENIX, ARIZONA

\*\*\*\*\* FOR OFFICIAL USE ONLY \*\*\*\*\*

DATE \_\_\_\_\_ INITIALS \_\_\_\_\_ VERIFIED \_\_\_\_\_



  
**DEPARTMENT OF THE INTERIOR**  
**BUREAU OF LAND MANAGEMENT**  
**MINING CLAIMS**  
**(MASS) Serial Register Page**

Run Date/Time: 08/29/16 04:37 PM

Page 1 c

01 05-10-1872;017STAT0091;30USC26,28,34

Total Acres  
20.660

Serial Number  
AMC425510

Case Type 384101: LODE CLAIM

Claim Name: BURRO CORRAL #1

Lead File Number  
AMC425510

Case Disposition: ACTIVE

Required Maintenance Fee: \$155.00

Name & Address

Int Rel

HENDRICKS KRIS  
2915 W MALIBU RD GOLDEN VALLEY, AZ 86413-8819

CLAIMANT

County / State

District

MOHAVE County, AZ

COLORADO RIVER DO

Mer Twp Rng Sec

Subdivision

14 0200N 0170W 006

NE

Act Date	Code	Action Text	Action Remarks	Receipt Number
09/17/2013	403	LOCATION DATE		
11/15/2013	395	RECORDATION NOTICE RECD	1	2912218
08/18/2015	782	MAINTENANCE FEE PAYMENT	2016;\$155	3370344
08/22/2014	782	MAINTENANCE FEE PAYMENT	2015;\$155	3109122
11/15/2013	484	LOCATION YEAR / MAINTENAN	2014;\$140	2912218
07/21/2014	669	LAND STATUS CHECKED		
11/15/2013	501	ACCT ADV IN LEAD FILE	AMC425510;	
09/17/2013	404	COUNTY RECORDATION	2013048696;	

Line Nr      Remarks

**United States Department of the Interior**  
**Bureau of Land Management**  
 DIV OF LANDS, MINRLS & ENERGY  
 ONE N CENTRAL AVE  
 PHOENIX, AZ 85004 -4427  
 Phone: 602-417-9200

Receipt

No: 3645734

<b>Transaction #:</b> 3749709	
<b>Date of Transaction:</b> 08/29/2016	
<b>CUSTOMER:</b>	
KRIS HENDRICKS 2915 W MALIBU RD GOLDEN VALLEY, AZ 86413-8819 US	

LINE #	QTY	DESCRIPTION	REMARKS	UNIT PRICE	TOTAL
1	1.00	LOCATABLE MINERALS / MINING CLAIMS- NOT NEW-UNADJUD, ONE AUTH NO. ONLY / MINING CLAIM MONEY RECEIVED CASES: AMC425510/\$155.00	MAINT 2017/1	- n/a -	155.00
<b>TOTAL:</b>					<b>\$155.00</b>

PAYMENT INFORMATION			
NOTE: Items will appear on credit card statement as "Bureau of Land Mgmt CO".			
1	AMOUNT:	155.00	POSTMARKED: N/A
	TYPE:	CREDIT CARD	RECEIVED: 08/29/2016
	NAME:	HENDRICKS, KRIS 2915 W MALIBU RD GOLDEN VALLEY AZ 86413-8819 US	
	CARD NO:	XXXXXXXXXXXX6086	AUTH CODE: 029686
	NAME ON CARD:	KRISTOPHER HENDRICKS	
	EXPIRES:	03/2019	
	SIGNATURE:		

REMARKS

This receipt was generated by the automated BLM Collections and Billing System and is a paper representation of a portion of the official electronic record contained therein.

425510

UNITED STATES  
DEPARTMENT OF THE INTERIOR  
BUREAU OF LAND MANAGEMENT

**CREDIT CARD PAYMENT**  
**For Mining Claim Maintenance Fee**

THIS IS A CHANGE OF ADDRESS

TELEPHONE SUBMISSION - ACCURACY OF THE BELOW INFORMATION IS THE RESPONSIBILITY OF THE CLAIMANT/OWNER

NAME Kris HENDRICK'S  
ADDRESS 2915 W Malibu Rd  
CITY Golden Valley STATE AZ ZIP 86413  
PHONE # 928 - 323-7683

SEND RECEIPT TO  Above address  
 Other (Include Name and Mailing Address):

\_\_\_\_\_  
\_\_\_\_\_  
\_\_\_\_\_

AMC NUMBER  
425510

CLAIM/SITE NAME  
Burro Corral #1

1 # of Claim/Site  
x 155.00 Each  
\$ 155 Total Charged EB (INITIALS)

RECEIPT # 3370344

DATE STAMP

ENTERED  
AUG 21 2015  
BY: RBA

RECEIVED  
BLM AZ STATE OFFICE  
PHOENIX, ARIZONA  
2015 AUG 18 P 2:06

\*\*\*\*\* FOR OFFICIAL USE ONLY \*\*\*\*\*  
DATE \_\_\_\_\_ INITIALS \_\_\_\_\_ VERIFIED \_\_\_\_\_

**United States Department of the Interior**  
**Bureau of Land Management**  
 LANDS/RECREATION & PLANNING  
 ONE N CENTRAL AVE  
 PHOENIX, AZ 85004 -2203  
 Phone: 602-417-9200

Receipt

No: 3370344

<b>Transaction #:</b> 3468499	
<b>Date of Transaction:</b> 08/18/2015	
<b>CUSTOMER:</b>	
KRIS HENDRICKS 2915 W MALIBU RD GOLDEN VALLEY, AZ 86413-8819 US	

LINE #	QTY	DESCRIPTION	REMARKS	UNIT PRICE	TOTAL
1	1.00	LOCATABLE MINERALS / MINING CLAIMS- NOT NEW-UNADJUD, ONE AUTH NO. ONLY / MINING CLAIM MONEY RECEIVED <b>CASES: AMC425510/\$155.00</b>	2016 MAINT (1)	- n/a -	155.00
<b>TOTAL:</b>					<b>\$155.00</b>

PAYMENT INFORMATION			
NOTE: Items will appear on credit card statement as "Bureau of Land Mgmt CO".			
1	AMOUNT:	155.00	POSTMARKED: N/A
	TYPE:	CREDIT CARD	RECEIVED: 08/18/2015
	NAME:	HENDRICKS, KRIS 2915 W MALIBU RD GOLDEN VALLEY AZ 86413-8819 US	
	CARD NO:	XXXXXXXXXXXX6709	AUTH CODE: 131799
	NAME ON CARD:	KRISTOPHER HENDRICKS	
	EXPIRES:	07/2019	
	SIGNATURE:		

REMARKS

This receipt was generated by the automated BLM Collections and Billing System and is a paper representation of a portion of the official electronic record contained therein.

**ENTERED**  
 AUG 21 2015  
 BY: *RJH*



425510

UNITED STATES  
DEPARTMENT OF THE INTERIOR  
BUREAU OF LAND MANAGEMENT  
**MAINTENANCE FEE PAYMENT FORM  
FOR PLACER MINING CLAIMS**

Remitter Name: Kris Hendricks  
Mailing Address: 2915 W. Malibu  
City, State, Zip: Golden Valley AZ 86413

Check here if this is a change of address.

**FOR COUNTY RECORDER'S USE**

No. of claims 1  
Total due BLM \$ 155.00

- The maintenance fee may be paid by cash, check, money order, Bureau of Land Management (BLM) Declining Deposit Account, or credit card (VISA, American Express, Discover, or MasterCard). Payments must be remitted to the BLM State Office where your claim or site is recorded and received on or before September 1. If the payment is mailed, the envelope must be postmarked by a bona fide delivery service on or before September 1 and received at the proper BLM State Office within 15 calendar days after the due date. Payments may also be made by telephone using a credit card. A complete listing of BLM State Offices with their addresses and phone numbers can be found at <http://www.blm.gov>.
- The maintenance fee for the following claim(s) applies to the assessment year 2014.

CLAIM NAME	BLM SERIAL NO.	ACRES IN CLAIM	PAYMENT DUE TO THE BLM (See Instructions on Page 2)
Burro Coral #1	AMC425510	20	155.00

RECEIVED  
 BLM AZ STATE OFFICE  
 2014 AUG 22 A 10:07  
 PHOENIX, ARIZONA

Use a separate sheet for additional claim names, serial numbers, and claimant names and addresses.

(Continued on page 2)

**ENTERED**  
 8-25-2014  
 BY: RE

**United States Department of the Interior  
Bureau of Land Management**

Receipt

**LANDS/RECREATION & PLANNING**  
ONE N CENTRAL AVE  
PHOENIX, AZ 85004 -2203  
Phone: 602-417-9200

No: 3109122

<b>Transaction #:</b> 3200810	
<b>Date of Transaction:</b> 08/22/2014	
<b>CUSTOMER:</b>	
KRIS HENDRICKS 2915 W MALIBU RD GOLDEN VALLEY, AZ 86413-8819 US	

LINE #	QTY	DESCRIPTION	REMARKS	UNIT PRICE	TOTAL
1	1.00	LOCATABLE MINERALS / MINING CLAIMS- NOT NEW-UNADJUD, ONE AUTH NO. ONLY / MINING CLAIM MONEY RECEIVED <b>CASES: AMC425510/\$155.00</b>	MAINT (1) 2015	- n/a -	155.00
<b>TOTAL:</b>					<b>\$155.00</b>

PAYMENT INFORMATION			
NOTE: Items will appear on credit card statement as "Bureau of Land Mgmt CO".			
1	AMOUNT:	155.00	POSTMARKED: N/A
	TYPE:	CREDIT CARD	RECEIVED: 08/22/2014
	NAME:	HENDRICKS, KRIS 2915 W MALIBU RD GOLDEN VALLEY AZ 86413-8819 US	
	CARD NO:	XXXXXXXXXXXX6086	AUTH CODE: 022768
	NAME ON CARD:	KRISTOPHER HENDRICKS	
	EXPIRES:	03/2015	
	SIGNATURE:		

REMARKS

This receipt was generated by the automated BLM Collections and Billing System and is a paper representation of a portion of the official electronic record contained therein.

**NOTICE!!**

**These documents have been scanned!**

**Do not place un-scanned documents beneath this notice!**

**Do not remove this notice from this file!**

GPO Jacket No. 560-102  
Print Order 61540  
Rise Business Services, LLC  
Job=AZ15 5/10/2019



Box Number= AZ15036



Claim Begin-End: AMC425510-AMC425510

6 Location Notices-Amendments and Supporting Documents



AZ15036-19

AMC425096-AMC425592

# MINING CLAIM STATUS REPORT

Data Entered: 11/22/2013

MTP Checked By: pm

GEO Checked By: pm

LEAD SERIAL NUMBER: AMC 425510 thru AMC \_\_\_\_\_

**NUMBER OF CLAIMS & TYPE:**

1 LODE  
\_\_\_\_ PLACER  
\_\_\_\_ ASSOCIATION PLACER  
\_\_\_\_ MILL SITE  
\_\_\_\_ TUNNEL SITE

**CHARGES:**

Location Fee @ \$34 = \$ 34.00  
Processing Fee @ \$20 = \$ 20.00  
Maintenance Fee @ \$140 = \$ 140.00  
Add'l Maint Fee for Assoc Placer = \$ \_\_\_\_\_  
**SUBTOTAL** \$ \_\_\_\_\_  
Other Fees \$ \_\_\_\_\_  
Other Fees \$ \_\_\_\_\_  
**TOTAL** \$ 194.00

**TOTAL ACREAGE:** \_\_\_\_\_ Per Claim  
(Placer Only)

**NUMBER OF LOCATORS:** \_\_\_\_\_

**DOCUMENTS RECEIVED VIA:** Over-the-Counter [ ] Mail [  ] **TIMELY FILED:** Yes [  ] No [ ]

**LEGAL DESCRIPTION:** T 20N R 17W SEC 6E  
T \_\_\_\_\_ R \_\_\_\_\_ SEC \_\_\_\_\_  
T \_\_\_\_\_ R \_\_\_\_\_ SEC \_\_\_\_\_  
T \_\_\_\_\_ R \_\_\_\_\_ SEC \_\_\_\_\_  
T \_\_\_\_\_ R \_\_\_\_\_ SEC \_\_\_\_\_

BLM [ ] FOREST SERVICE [ ] \_\_\_\_\_ SUBJ TO PL 359: Yes [ ] No [ ]  
WILDERNESS AREA [ ] \_\_\_\_\_

**SPLIT ESTATE:** N/A [ ] SX [ ] PX [ ] OTHER [ ] \_\_\_\_\_  
SRHA [ ] Was proper Notice filed if located on SHRA Land? Yes [ ] No [ ]

**RECONVEYED MINERALS ON BLM LAND REQUIRE OPENING ORDER FROM 1944 TO 1993:**

Open to Entry On \_\_\_\_\_ N/A [ ]

**COMMENTS/STATUS:** VOID [ ] PARTIALLY VOID [ ] PVT MINERALS [ ] WITHDRAWN LANDS [ ]  
OTHER [ ] \_\_\_\_\_

Not a good metes and bounds description

[ ] Claimant acknowledges that portions of the following claim(s) site(s) may be void or voidable.

Printed Name of Claimant \_\_\_\_\_ Signature of Claimant \_\_\_\_\_

\*\*\*\*\*FINAL ADJUDICATION\*\*\*\*\*

DATE 7/21/14 INITIALS AT

AMC425510





FEE# 2013048696

OFFICIAL RECORDS  
OF MOHAVE COUNTY  
CAROL MEIER,  
COUNTY RECORDER



09/17/2013 10:33 AM Fee: \$10.00

PAGE: 1 of 2

LOCATION NOTICE FOR LODE MINING CLAIM

NOTICE IS HEREBY GIVEN that the Burro Corral #1  
lode mining claim has been located  
by Kris Hendricks whose current mailing  
address is 2915 W. Malibu Golden Valley  
AZ 86413

Ret

RECEIVED  
BLM  
Date  
Stamp  
NOV 15 PM 2:40  
PHOENIX, ARIZONA

The general course of this claim is North South and it is situated in Mohave  
County, Arizona. This claim is 1500 feet in length and 600 feet in width. This claim runs  
from the location monument on which this location notice is posted approximately 750 feet in a  
North direction to the Western end line and 750 feet in a South direction to the  
Southern end line. This claim is marked by six monuments, one at each corner and one at the center of each  
end line of the claim.

The location monument on which this notice is posted is situated within Section 5, Township 20 N  
N, Range 17 W, Gila Salt River Base and Meridian, Arizona and this claim encompasses portions  
of the following quarter section (s), section (s), Township (s) and Range (s) NE North East  
Sec. #6 Township 20N Range 17 W  
Gila Salt River Base and Meridian, Arizona.

The locality of this claim with reference to some natural object or permanent monument and additional information  
(if any) concerning its locality are as follows: NE Corner is 66 Feet E of  
USGS Section Corner 32.33 T 21 N NW corner  
To Burro Corral Fence By Corner at NE corner of

DATED AND POSTED on the ground this 17 day of September, 2013

LOCATOR (s) [Signature]

ENTERED  
NOV 22 2013  
BY: [Signature]

Form MCF100  
Revised July 2005

**MINING CLAIM MAP**

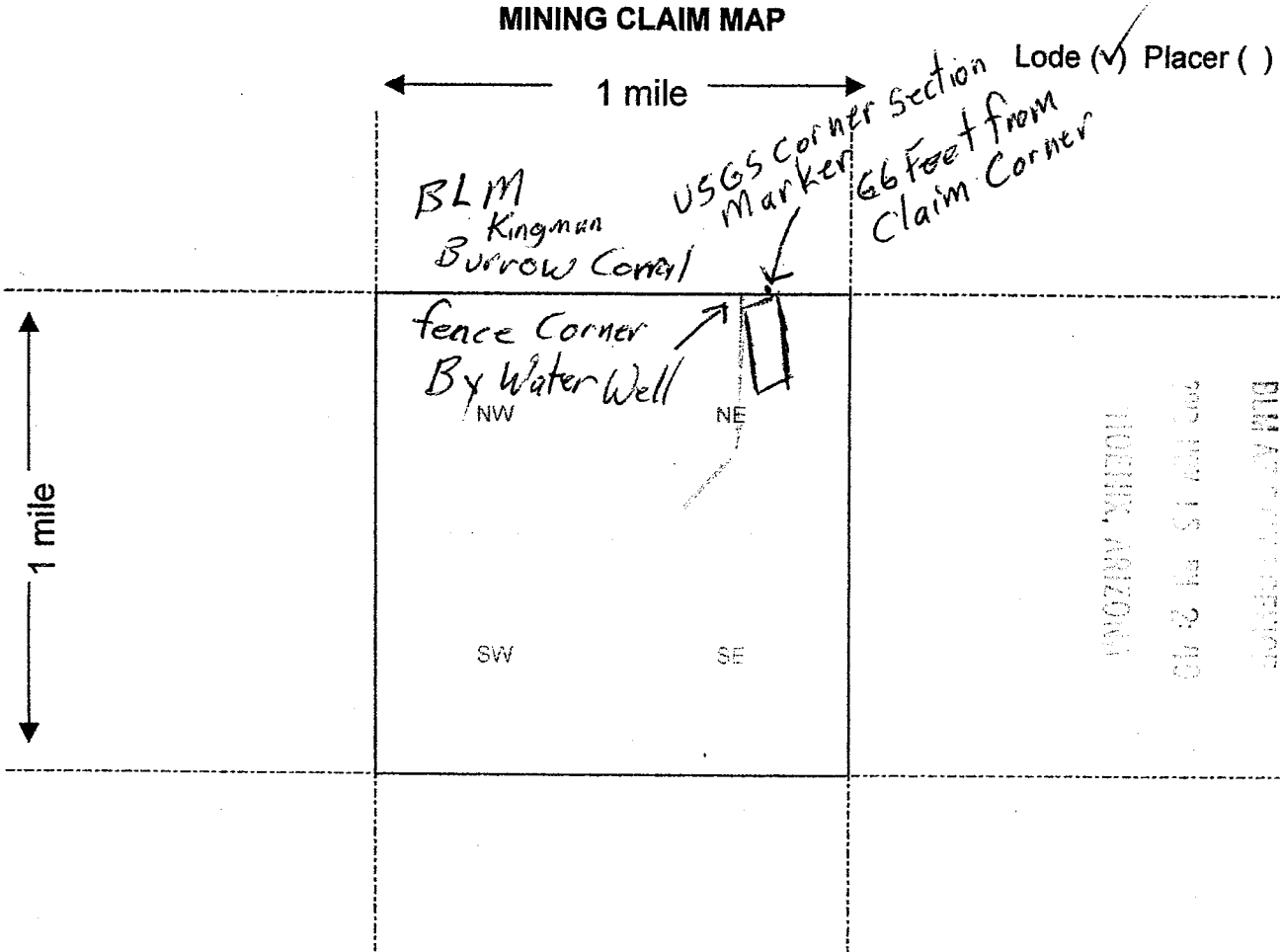

Scale : 1" = 2000 feet



1. The above map depicts the Burro Corral #1 mining claim, which is located in Section (s) NE 6, Township 20 N, Range 17 W, Gila and Salt River Base and Meridian, Mohave County, Arizona.

2. The type of corner and location monuments used are as follows: 2x2 Wood Painte White on top  
2 Foot orange survey tap 4x4 Location in center

3. The bearings and distances in degrees and feet between claim corners are as depicted on the map.

Form MCF100a  
Revised July 2005

This form is available from the Arizona Department of Mines & Mineral Resources and may be reproduced.

RECEIVED  
DLM AT THE OFFICE  
JUL 15 04 2 40  
MOHAVE, ARIZONA

1100425510

Input Parameters for Geographic Report with Land

System Id = CR

Admin State = AZ

Geo State =

Casetype Begins With

Case Disp Txt = AUTHORIZED, CANCELLED, EXPIRED, PENDING, REJECTED, RELINQUISHED, VOID, WITHDRAWN

Mer Twp Rng = 14 0200N 0170W

Section = 006, 999

Mtrs =

Commodity =

Commodity Txt =

Pending Org =

Pend Org Decode =

Total Rows Returned: 23

RUN TIME: 04:11 PM

UNITED STATES DEPARTMENT OF INTERIOR  
BUREAU OF LAND MANAGEMENT  
GEOGRAPHIC REPORT WITH LAND  
Sorted by Serial Number

RUN DATE: 11/22/2013  
Page 1 of 4

Adm State: AZ

Serial Number: AZA 003340  
Total Case Acres: 5.750

<u>Casetype</u>	<u>Case Disp</u>	14	0200N	0170W	<u>Sect</u>	<u>Sur Typ</u>	<u>Sur Num</u>	<u>Suff</u>	<u>Subdivision</u>	<u>Act Pend</u>
285003	AUTHORIZED				006	ALIQ LOTS			N2SE; 6,7,9-11,16-18;	

Serial Number: AZA 016998  
Total Case Acres: 17.220

<u>Casetype</u>	<u>Case Disp</u>	14	0200N	0170W	<u>Sect</u>	<u>Sur Typ</u>	<u>Sur Num</u>	<u>Suff</u>	<u>Subdivision</u>	<u>Act Pend</u>
285003	AUTHORIZED				006	ALIQ			SESE;	

Serial Number: AZA 020668  
Total Case Acres: 9.720

<u>Casetype</u>	<u>Case Disp</u>	14	0200N	0170W	<u>Sect</u>	<u>Sur Typ</u>	<u>Sur Num</u>	<u>Suff</u>	<u>Subdivision</u>	<u>Act Pend</u>
281001	AUTHORIZED				006	ALIQ LOTS			E2SE; 5-7,9-11,15-18;	

Serial Number: AZA 021021  
Total Case Acres: 283.250

<u>Casetype</u>	<u>Case Disp</u>	14	0200N	0170W	<u>Sect</u>	<u>Sur Typ</u>	<u>Sur Num</u>	<u>Suff</u>	<u>Subdivision</u>	<u>Act Pend</u>
281001	AUTHORIZED				006	MNR		1	SESESESE;	

Serial Number: AZA 023594  
Total Case Acres: 0.320

<u>Casetype</u>	<u>Case Disp</u>	14	0200N	0170W	<u>Sect</u>	<u>Sur Typ</u>	<u>Sur Num</u>	<u>Suff</u>	<u>Subdivision</u>	<u>Act Pend</u>
285003	AUTHORIZED				006	ALIQ			E2SE;	





RUN TIME: 04:11 PM

UNITED STATES DEPARTMENT OF INTERIOR  
BUREAU OF LAND MANAGEMENT  
GEOGRAPHIC REPORT WITH LAND  
Sorted by Serial Number

RUN DATE: 11/22/2013  
Page 3 of 4

Adm State: AZ

360412 PENDING 006 ALIQ SE;

Serial Number: AZA 035455  
Total Case Acres: 2.010

<u>Casetype</u>	<u>Case Disp</u>	14	0200N	0170W	<u>Sect</u>	<u>Sur Typ</u>	<u>Sur Num</u>	<u>Suff</u>	<u>Subdivision</u>	<u>Act Pend</u>
285003	AUTHORIZED				006	LOTS			2,3,12,39;	

Serial Number: AZA 035922  
Total Case Acres: 1.000

<u>Casetype</u>	<u>Case Disp</u>	14	0200N	0170W	<u>Sect</u>	<u>Sur Typ</u>	<u>Sur Num</u>	<u>Suff</u>	<u>Subdivision</u>	<u>Act Pend</u>
361113	AUTHORIZED				006	ALIQ			SE;	

Serial Number: AZA 035956  
Total Case Acres: 1.000

<u>Casetype</u>	<u>Case Disp</u>	14	0200N	0170W	<u>Sect</u>	<u>Sur Typ</u>	<u>Sur Num</u>	<u>Suff</u>	<u>Subdivision</u>	<u>Act Pend</u>
361113	PENDING				006	ALIQ			SE;	

Serial Number: AZA 036174  
Total Case Acres: 1.000

<u>Casetype</u>	<u>Case Disp</u>	14	0200N	0170W	<u>Sect</u>	<u>Sur Typ</u>	<u>Sur Num</u>	<u>Suff</u>	<u>Subdivision</u>	<u>Act Pend</u>
380913	AUTHORIZED				006	ALIQ			E2;	

Serial Number: AZA 036184  
Total Case Acres: 1.000

<u>Casetype</u>	<u>Case Disp</u>	14	0200N	0170W	<u>Sect</u>	<u>Sur Typ</u>	<u>Sur Num</u>	<u>Suff</u>	<u>Subdivision</u>	<u>Act Pend</u>
362213	AUTHORIZED				006	ALIQ			SE;	

RUN TIME: 04:11 PM

UNITED STATES DEPARTMENT OF INTERIOR  
BUREAU OF LAND MANAGEMENT  
GEOGRAPHIC REPORT WITH LAND  
Sorted by Serial Number

RUN DATE: 11/22/2013  
Page 4 of 4

Adm State: AZ

Serial Number: AZA 036193  
Total Case Acres: 1.000

<u>Casetype</u>	<u>Case Disp</u>	14	0200N	0170W	<u>Sect</u>	<u>Sur Typ</u>	<u>Sur Num</u>	<u>Suff</u>	<u>Subdivision</u>	<u>Act Pend</u>
361113	AUTHORIZED				006	ALIQ			SE;	

Serial Number: AZA 036344  
Total Case Acres: 40.000

<u>Casetype</u>	<u>Case Disp</u>	14	0200N	0170W	<u>Sect</u>	<u>Sur Typ</u>	<u>Sur Num</u>	<u>Suff</u>	<u>Subdivision</u>	<u>Act Pend</u>
362113	PENDING				006	LOTS			19,20,23,24;	

Serial Number: AZPHX 0034352  
Total Case Acres: 424.177

<u>Casetype</u>	<u>Case Disp</u>	14	0200N	0170W	<u>Sect</u>	<u>Sur Typ</u>	<u>Sur Num</u>	<u>Suff</u>	<u>Subdivision</u>	<u>Act Pend</u>
285003	AUTHORIZED				006	ALIQ			SESE;	

Serial Number: AZPHX 0085710  
Total Case Acres: 387.880

<u>Casetype</u>	<u>Case Disp</u>	14	0200N	0170W	<u>Sect</u>	<u>Sur Typ</u>	<u>Sur Num</u>	<u>Suff</u>	<u>Subdivision</u>	<u>Act Pend</u>
285004	AUTHORIZED				006	ALIQ LOTS		1	N2SE; 17,26;	



Kris Hendricks  
2915 W Alibu  
G.V. AZ 86413

PHOENIX AZ 850

14 NOV 2013 PM 8 L



RECEIVED  
BLM STATE OFFICE

B.L.M.

2013 NOV 15 PM 2:39

One N Central AVE.

Phoenix AZ 85004-2203

85004442700

